

Toshiba's Industrial Label Printer Range

Toshiba offer a variety of Industrial Label Printers that range from 4" to 8", designed to fit all Industrial Label applications.

Industrial Label Printers

- | | | |
|-----------|-----------|----------|
| 4" | 6" | 8" |
| > B-EX4T1 | > B-EX6T1 | > B-SX8T |
| > B-EX4D2 | B-EX6T3 | > B-852 |
| B-EX4T2 | | |



B-EX4T1 4" Industrial Printer

Product brochure

- > A premium range of industrial printers with a mid-range price tag for a wide variety of applications.
- > We have combined 60 years of Label Printer knowledge, our extensive R&D and the voice-of-customer feedback with the exceptional qualities of our market-leading printer range.
- > Enjoy the enhanced performance, serviceability and green credentials of this extraordinary thermal printer series.



Fast and Flexible

With a speed of up to 14 ips the B-EX4T1 boasts a 44% productivity improvement over the B-SX4/5 range. In addition, advanced processing capabilities facilitate high throughput.

Usability

Easy operations, including a user-replacable snap-in printhead and platen roller, minimise maintenance costs. The unique and intuitive-to use graphical display improves operability and lets even the novice user create impeccable labels.

SPECIFICATIONS

General

Print Method	Direct thermal/Thermal transfer
Printhead	Near edge
Dimensions (W x D x H)	278 x 460 x 310 mm
Weight	17 kg
Memory	16 MB (FROM), 32 MB (SRAM)
User interface	Graphic LCD, 2 x LED, 10 x key
Operating Temperature / Humidity	5°C to 40°C / 25-85% non-condensing relative humidity (RH)
Storage Temperature / Humidity	-40°C to 60°C / 10-90% non-condensing relative humidity (RH)
Power supply	AC 100 to 240V, 50/60 Hz

Print

Resolution	GS/TS: 203/305 dpi (8/12 dots/mm)
Sensor	Reflective, Transmissible
Maximum Print Speed	335 mm/second (14 ips)
Maximum Print Width	104 mm
Print Length	Batch: 8-1,498 mm Cut: 23.4-1,494 mm Peel-off: 23.4-254 mm
Barcodes	UPC/EAN/JAN, Code 39, Code 93, Code 128, NW7, MSI, Interleaved 2 of 5, Industrial 2 of 5, Matrix 2 of 5, Postnet, RM4SCC, KIX-Code, Customer Barcode, GS1 Databar
2D Codes	Data Matrix, PDF 417, Maxicode, QR Code, Micro PDF 417, CP Code
Fonts	Bitmap font, Outline font, Price font, Optional TTF, Writable character

Media

Alignment	Centred
Backing Paper Width	30-120 mm
Label Thickness	0.13-0.17 mm
Inner Media Core Diameter	76.2 mm
Outer media Roll Diameter	200 mm
Media Type	Vellum labels and paper, Matt coated paper, Glossy coated paper, Synthetic film, PET film, Polyimide
Media Format	Roll, Fanfold

Software & Connectivity

Emulation	ZPL II
Printer Driver	Windows 10/8/7/Vista (32/64 bit), Windows Server 2012/Server 2008 (32/64 bit)
Interface	Parallel, Serial, USB 2.0, LAN 10/100 Base, RS232 ¹⁾ , Centronics ¹⁾ , Wireless LAN ¹⁾
Language Mode	TPCL, BCI (function)
Label Software	BarTender UltraLite

Ribbon

Ribbon Width	41-112 mm
Ribbon Core Size	25.4 mm (1 inch)
Max. Ribbon Length	800 m
Max. Ribbon Diameter	90 mm

Options

Cutter, Rotary cutter, Peel-off & internal rewinder, RFID kit, Ribbon save module, RTC USB host

¹⁾ Optional

B-EX4D2 B-EX4T2

4" Industrial Printer

Product brochure

- > The B-EX4D2 and B-EX4T2 printing solutions feature high quality and economical industrial products which deliver low running costs and total cost of ownership.
- > Available in a variety of resolutions for the most diverse industrial printing applications they easily integrate into existing workflows.
- > Free your business from the constraints legacy systems - simply plug and print.



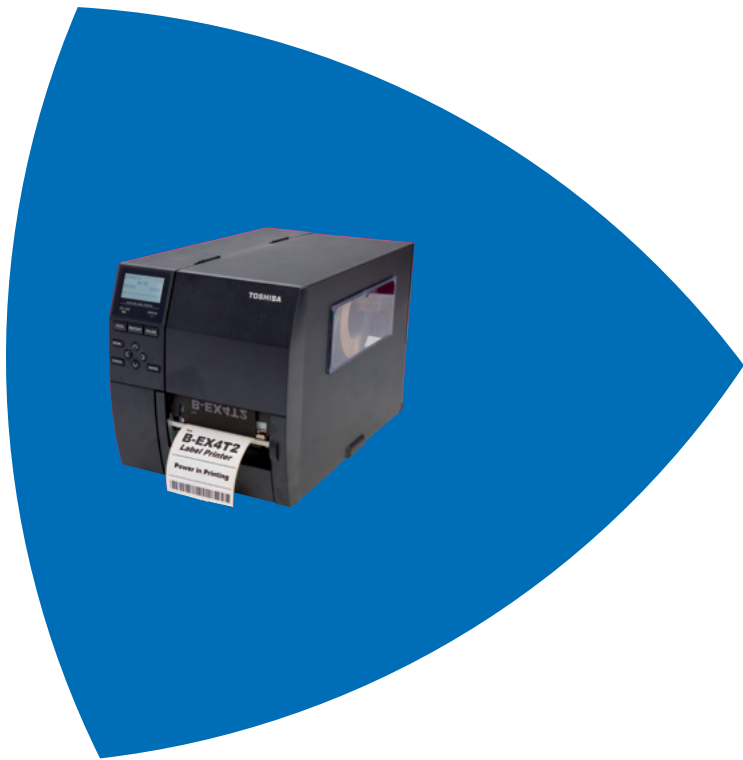

HIGH PERFORMANCE AT LOW COSTS

With speeds of up to 12 ips, the 4 inch B-EX4D2 and B-EX4T2 range were made for demanding industrial printing. Advanced processing power ensures not only fast output, but also efficient throughput.

Compatibility

Both series were designed to seamlessly replace existing products, using Z-Mode emulation to integrate into legacy software systems. Flat-head technology, left justified media and the use of inside and outside wound ribbons allows for replacement of ageing and costly to operate printing estates (with easy transition from old label and ribbon stock).

Ribbon & Media

Left-hand aligned media, with the option for inside or outside wound ribbon, ensures compatibility and competitiveness within the media marketplace. An 600 m ribbon is also available, for fewer media changes and further lowering the total cost of ownership.

Easy Maintenance

With innovative technology like double-ribbon motor control, snap-in printheads and field upgradeable options, the B-EX4D2 and B-EX4T2 series continue to lower maintenance costs.

Specialist printing

All models are available in either 203, 300 or 600¹⁾ dpi variants, allowing for specialist high-resolution printing with superior print quality.

¹⁾ B-EX4T2 only

APPLICATIONS

Industrial printing can be very demanding and you need systems you can rely on to keep your business workflows running smoothly. With Toshiba's B-EX4D2 and B-EX4T2 series you have high-performance models available which increase your efficiency while at the same time ensuring economical benefits.

Key highlights

- Low cost industrial printing
- Flat head for compatibility with legacy estates
- Cost-effective, for legacy system replacement
- High-specification, high-throughput, high-performance and extremely durable
- Media compatibility
- Extra-long ribbon (600 m) for increased productivity
- USB and Ethernet as standard; serial, parallel, USB host and WLAN are optional
- Emulation for quick & easy replacement of competitor's products

SPECIFICATIONS

General

Print Method	B-EX4D2: Direct thermal B-EX4T2: Direct thermal/Thermal transfer
Printhead	Flat head
Dimensions (W x D x H)	278 x 460 x 310 mm
Weight	17 kg
Memory	16 MB (FROM), 32 MB (SRAM)
User interface	Graphic LCD, 2 x LED, 10 x key
Operating Temperature / Humidity	-40°C to 60°C / 10-90% non-condensing relative humidity (RH)
Storage Temperature / Humidity	5°C to 40°C / 25-85% non-condensing relative humidity (RH)
Power supply	AC 100 to 240V, 50/60 Hz AC adapter

Print

Resolution	GS/TS/HS: 203/300 dpi (8/11.8 dots/mm) HS ¹⁾ : 600 dpi (23.6 dots/mm)
Sensor	Reflective, Transmissible
Maximum Print Speed	GS & TS: 305 mm/second (12 ips) HS ¹⁾ : 152 mm/second (6 ips)
Maximum Print Width	104 mm
Print Length	B-EX4D2 B-EX4T2 Batch: 8-1,498 mm Batch: 8-1,498 mm Cut: 19-1,494 mm Cut: 23.4-1,494 mm Peel-off: 13-254 mm Peel-off: 23.4-254 mm
Barcodes	UPC/EAN/JAN, Code 39, Code 93, Code 128, EAN 128, NW7, MSI, Interleaved 2 of 5, Industrial 2 of 5, Matrix 2 of 5, Postnet, RM4SCC, KIX-Code, Customer Barcode, GS1 Databar
2D Codes	Data Matrix, PDF 417, Maxicode, QR Code, Micro PDF 417, CP Code
Fonts	Bitmap font, Outline font, Price font, Writeable character, Optional True Type

Ribbon¹⁾

Ribbon Width	41-112 mm
Ribbon Core Size	25.4 mm (1 inch)
Max. Ribbon Length	600 m
Max. Ribbon Diameter	90 mm

Media

Alignment	Left
Backing Paper Width	25-114 mm
Media Thickness	Label: 0.13-0.17 mm Tag: 0.08-0.17 mm
Inner Media Core Diameter	76.2 mm
Outer media Roll Diameter	200 mm
Media Type	Vellum paper and labels, Matt coated paper, Glossy coated paper, Synthetic film, PET film, Polyimide
Media Format	Roll, Fanfold

Software & Connectivity

Emulation	ZPL II, DPL
Printer Driver	Windows 10/8/7/Vista (32/64 bit), Windows Server 2012/Server 2008 (32/64 bit)
Interface	USB 2.0, LAN 10/100 Base, RS232 ²⁾ , Centronics ²⁾ , Wireless LAN ²⁾
Language Mode	TPCL, BCI (function)
Label Software	BarTender UltraLite

Options

For B-EX4D2/T2	Cutter, Peel-off & internal rewinder, RTC USB host, RS232, Centronics, Wireless LAN
-----------------------	---

¹⁾ B-EX4T2 only
²⁾ Optional

BarTender
BY SEAGULL SCIENTIFIC®
Create and automate labels, barcodes and more

Intuitive usage for utmost efficiency.

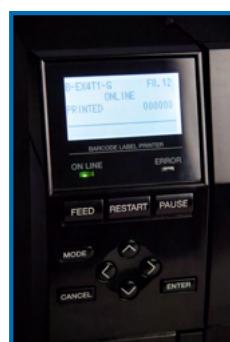

B-EX6T1 B-EX6T3 6" Industrial Printer

Product brochure

- › The Toshiba B-EX6 series — redefining the Industrial printer marketplace. Combining market leading technology with usability, reliability and the lowest total cost of ownership.
- › Extending the capabilities of our existing range of B-EX printers to cover the most demanding applications, for heavy duty industrial printing.
- › Rugged and durable design, advanced functionality, cost saving features and a wide choice of models and options for the best “all-in-one” industrial solution.



FLEXIBLE. DURABLE. RELIABLE.

Cost of Ownership

Performance and functionality to meet the demands of the wide-web printing marketplace, designed with features and options to offer the lowest cost of ownership; including an extended long-life print head; Toshiba's unique ribbon save mode and an 800 m ribbon, to improve efficiencies and ultimately reduce costs over the life of the printer.

Flexible Design

The B-EX6 has been designed with the same durability and reliability as the B-EX4 range, with rugged and robust outer casing. We have added more: a bi-cover to reduce footprint and opening space and essential operator usability, for ease of operation, reduced maintenance costs and minimal down-time.

Improve your efficiency

Supporting 6 inch media, with speeds of up to 12 inches per second, the B-EX6 range can handle the most demanding printing applications. In addition, high throughput is facilitated with advanced processing capabilities, increasing overall efficiency and productivity.

Enhanced connectivity

For flexible connectivity options, USB and Ethernet come as standard on the B-EX6 series. The optional Bluetooth functionality allows for parameter settings directly from your smart phone or mobile device.

Range of Models

A choice of models to suit any application, with 200 and 300 dpi variants for superior print quality and perfect readability of barcodes. Flat head and near edge head models enable easy replacement of legacy printer estates, and a wide range of media and options offer flexibility for any printing application.

Applications

The B-EX6 series combines the tried and trusted features and functionality of the current B-EX range.

Reliability and performance usually come at a cost but, with the B-EX series, premium capabilities come as standard, essentially lowering initial capital outlay and future-proofing your investment.

- > Industry
 - Automotive, Chemical, Pharmaceutical, Textile, Electronics, Food & Beverages
- > Manufacturing
 - Carton label, Rating label, Picking label, Parts label
- > Government
 - Utilities
- > Retail Distribution
 - Multiple label (Price label, shelf tag)
- > Transport and Logistics
 - Shipping/Receiving label, Address label, Pallet label
- > Healthcare
- > Telecommunications

Key Highlights

- > Combining market leading technology with usability, reliability and the lowest total cost of ownership
- > High speed; high throughput
- > Rugged, robust and durable, with easy operation

Improved productivity,
lower cost of ownership.

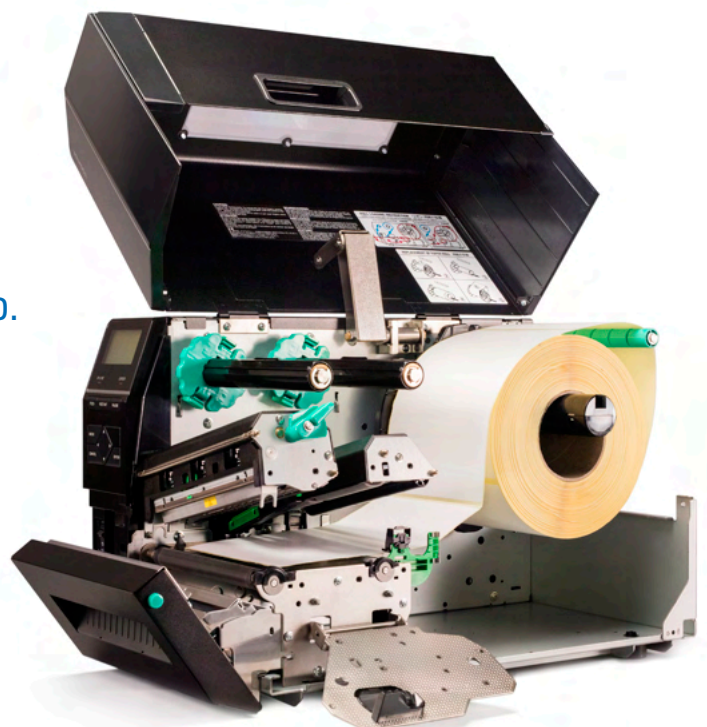

SPECIFICATIONS

General

Print Method	Direct thermal/Thermal transfer
Printhead	T1: Near edge head T3: Flat head
Dimensions (W x D x H)	331 x 460 x 310 mm
Weight	20 kg
Memory	16 MB (FROM), 32 MB (SRAM)
User interface	Graphic LCD, 2 x LED, 10 x key
Operating Temperature / Humidity	5°C to 40°C / 25-85% non-condensing relative humidity (RH)
Storage Temperature / Humidity	-40°C to 60°C / 10-90% non-condensing relative humidity (RH)
Power supply	AC 100 to 240V, 50/60 Hz

Print

Resolution	203/305 dpi (8/12 dots/mm)
Max. Print Speed	76/127/203/254/305 mm/second (3/5/8/10/12 ips)
Max. Print Width	160 mm
Max. Print Length	1,480 mm

Barcodes	EAN8, EAN13, JAN8, JAN12, UPC-A, UPC-E, NW-7, CODE 39, Code 93, ITF, MSI, Code 128, EAN 128, Industrial, 2 of 5, Customer Barcode, POSTNET, RM4SCC, KIX CODE, GS1 DataBar
2D Codes	Data Matrix, PDF 417, Maxicode, QR Code, Micro PDF 417, CP Code
Fonts	Bitmap font, Outline font, Price font, TTF, OFT, Writable characters, Optional True Type

Ribbon

Ribbon Width	max. 170 mm
Ribbon Core Size	25.4 mm (1 inch)
Max. Ribbon Length	Standard 600 m, Optional 800 m
Max. Ribbon Diameter	90 mm

Toshiba Genuine Ribbons.

Toshiba Genuine ribbons save you money.

Did you know Toshiba has a full range of approved thermal ribbons, for any printer or application?

Toshiba Genuine ribbons feature our unique Near Edge Technology, which enables fast keying time and no show through print.

For crisp barcodes, low energy settings and high speed solutions, contact us today.

Toshiba Genuine: Join the Near Edge Revolution.

Media

Alignment	Centre
Backing Paper Width	50-165 mm
Label Thickness	0.13-0.17 mm
Tag Thickness	0.08-0.25 mm
Inner Media Core Diameter	40-76.2 mm
Outer Media Roll Diameter	200 mm
Media Type	Roll, Fanfold

Software & Connectivity

Emulation	ZPL II
Printer Driver	Windows 10/8/7/Vista (32/64 bit), Windows Server 2012/Server 2008 (32/64 bit)
Interface	USB 2.0, LAN 10/100 Base, IPv6, USB Host/RTC, RS232 ¹⁾ , Centronics ¹⁾ , Wireless LAN ¹⁾ , EX I/O ¹⁾
Language Mode	TPCL, BCI (function)
Label Software	BarTender UltraLite

Options

Disc cutter, Peel-off module, RS232, Fan fold guide, Centronics, Wireless LAN, EX I/O, RFID²⁾

¹⁾ Optional

²⁾ For T1 model only

BarTender
BY SEAGULL SCIENTIFIC®
Create and automate
labels, barcodes and more



B-SX8T 8" Industrial Printer

Product brochure

- > The B-SX8 industrial printer from Toshiba with powerful networking delivers outstanding performance for a wide variety of environments and applications.
- > This innovative printer offers advanced features including extremely fast processing, large internal memory, web printer controls and outstanding SNMP networking tools.



KEY HIGHLIGHTS

- Advanced connectivity features
- Higher processing speed to improve data processing of large files
- Easy maintenance and low cost of ownership



APPLICATIONS

The Toshiba B-SX8 printer with the ultimate in networking tools is ideal for for a large range of applications:

- Logistics
 - Shipping/Receiving label, address label, container label
- Manufacturing
 - Carton label, Rating label, Picking label, Parts label
- Other Industries
 - e.g. Automotive, Paper, Chemical, Pharmaceutical, Textile

WITH PEACE OF MIND BUILT IN

Speed and Functionality

Utilising field-proven CPU technology from Toshiba the B-SX8 model offers high-speed printing and enhanced processing via an extensive choice of interfaces - including USB and internal LAN. The options of serial and wireless LAN interfaces provide additional flexibility and choice, making this printer adaptable to the widest variety of environments and applications.

High Print Quality

The high-resolution, wide print head of the B-SX8 facilitate speedy printing of large format compliance labels. A floating print head mechanism guarantees superb print quality with reduced friction and a flat paper path. The standard ribbon save function conserves the ribbon when it is not required, reducing costs and the amount of down-time required for ribbon changing.

Future Proofing

For future proofing, the B-SX8 printer is compatible with legacy systems. With the powerful Basic Command Interpreter (BCI) program, incoming data can be manipulated to generate the correct label formats. The BCI can also communicate with external devices allowing the easy integration of other technology systems.

SNMP Tools

The B-SX8 comes with a free Central Network Management Suite that allows the user to:

- Manage all the Toshiba printers attached to the network through their IP address.
- Exhibit system information and firmware versions, allowing firmware to be updated across the network simultaneously.
- View the status of each individual printer connected to the network in real-time with real-time alerts; including viewing web pages.
- View a graphical display of the alerted error with instructions on the actions necessary to resolve it.

Lower Cost of Ownership

This Toshiba product is manufactured at Toshiba's own facilities providing the assurance of complete reliability and quality of key components essential for low overall cost of ownership (TCO). To further lower the TCO the B-SX8 printer has large internal memory as standard with no requirement for additional memory.

SPECIFICATIONS

General

Print Method	Thermal transfer/Direct thermal
Printhead	Edge type
Dimensions (W x D x H)	416 x 289 x 395 mm
Weight	25 kg
Memory	16 MB (FROM), 16 MB (SRAM)
User interface	2 line LCD (16 characters), 3 x LED, 3 x key
Operating Temperature / Humidity	5°C to 40°C / 25-85% non-condensing relative humidity (RH)
Storage Temperature / Humidity	-40°C to 60°C / 10-90% non-condensing relative humidity (RH)
Power Supply	AC 100 to 240 V, 50/60 Hz

Print

Resolution	305 dpi (12 dots/mm)
Sensor	Reflective, Transmissible
Maximum Print Speed	203 mm/second (8 ips)
Maximum Print Width	213.3 mm
Maximum Print Length	Batch: 8-1,364 mm Cut: 23-1,364 mm Peel-off: 20.9-1,364 mm
Barcodes	UPC/EAN/JAN, Code 39, Code 93, Code 128, EAN 128, NW7, MSI, Interleaved 2 of 5, Industrial 2 of 5, Matrix 2 of 5, Postnet, RM4SCC, KIX-Code, GS1 Databar
2D Codes	Data Matrix, PDF 417, Maxicode, QR Code, Micro PDF 417, CP Code
Fonts	Bitmap font, Outline font, Price font, TTF, Writable characters

Ribbon

Ribbon Width	115-224 mm
Ribbon Core Size	25.4 mm (1 inch)
Fixed Core Length	228 mm
Max. Ribbon Length	300 m
Max. Ribbon Diameter	72 mm

Media

Alignment	Centred
Backing Paper Width	101.6 - 225 mm
Label Thickness	0.13-0.17 mm
Tag Thickness	0.10-0.17 mm
Inner Media Core Diameter	76 mm
Outer Media Roll Diameter	203 mm
Media Type	Vellum paper and labels, Matt coated paper, Glossy coated paper, Synthetic film, PET film, Polyimide
Media Format	Roll, Fanfold

Software & Connectivity

Printer Driver	Windows 10/8/7/Vista (32/64 bit), Windows Server 2012/Server 2008 (32/64 bit)
Interface	Parallel port, USB 2.0, LAN (10/100Base), Serial port ¹⁾ , Expansion I/O ¹⁾
Language Mode	TPCL, BCI (function)
Label Software	BarTender UltraLite

Options

Cutter module, Strip module, Serial interface board, Expansion I/O board, RTC (real time clock)

¹⁾ Optional



BarTender
BY SEAGULL SCIENTIFIC
Create and automate labels, barcodes and more

B-852

8" Industrial Printer

Product brochure

- > With powerful networking capabilities, the B-852 wide web printer from Toshiba delivers exceptional performance for a wide variety of environments and applications.
- > This innovative industrial printer offers superior features including extremely fast processing, large internal memory, web printer controls and outstanding SNMP networking tools.



APPLICATIONS

The Toshiba B-852 printer with exceptional performance and the ultimate in networking tools with impressive capacity to adapt to various working environments.

- > Manufacturing
 - to print carton labels, rating labels, picking labels, parts labels etc.
- > Transport and Logistics
 - to print shipping/receiving labels, address labels, pallet labels etc.
- > All industries which need to process and print large label sizes at high speed
 - e.g. Automotive, Heavy Industry, Steel Industry, Paper Industry, Forestry, Chemical Industry, Pharmaceutical Industry, Textile Industry, Retail Distribution

Speed and Functionality

Utilising field-proven CPU technology from Toshiba, the B-852 offers high-speed printing and enhanced processing via an extensive choice of interfaces – including USB 2.0 and internal LAN. The options of serial and LAN interfaces provide additional flexibility and choice, making the B-852 adaptable to the widest variety of environments and applications.

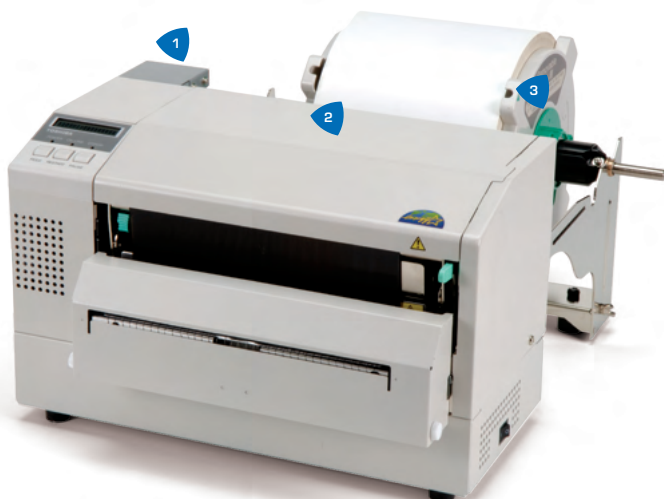
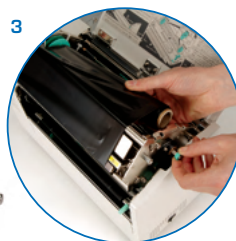
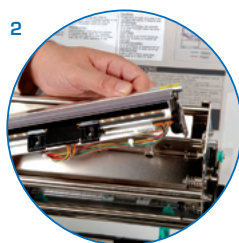

POWERFUL PRINTING

High Print Quality

The B-852 300 dpi, 216 mm wide printhead facilitates rapid printing of high-quality, large format compliance labels.

Future Proofing

For future proofing, the B-852 printer is compatible with legacy systems. With the powerful Basic Command Interpreter (BCI) programme, incoming data can be manipulated to generate the correct label formats. The BCI can also communicate with external devices allowing the easy integration of other technology systems.

SNMP Tools

The B-852 comes with a free Network Management Suite that allows the user to:

- > Manage all the Toshiba printers attached to the network through their IP address.
- > Display system information and firmware versions, allowing firmware to be updated across the network simultaneously.
- > View the status of each individual printer connected to the network in real time with real-time alerts (including viewing web pages).
- > View a graphical display of the alerted error with the instructions necessary to resolve it, even emailing the service call centre number when needed.

Lower Cost of Ownership

Manufactured at Toshiba's own facilities this printer provides the assurance of complete reliability and quality of key components, which is essential for low overall cost of ownership (TCO). To lower the TCO even further the B-852 has large internal memory as standard with no requirement for additional memory.

SPECIFICATIONS

General

Print Method	Thermal transfer/Direct thermal
Printhead	Flat head
Dimensions (W x D x H)	385 x 181 x 243 mm 429 x 427 x 265 mm with supply holder installed
Weight	15.6 kg
Memory	16 MB (FROM), 16 MB (SRAM)
User interface	LCD (16 digits), 3 x LED, 3 x key
Operating Temperature / Humidity	5°C to 40°C / 25-85% non condensing relative humidity (RH)
Storage Temperature / Humidity	-40°C to 60°C / 10-90% non condensing relative humidity (RH)
Power Supply	AC 100 to 240 V, 50/60 Hz

Print

Resolution	300 dpi (11.8 dots/mm)
Sensor	Reflective, Transmissible
Maximum Print Speed	101.6 mm/second (4 ips)
Maximum Print Width	216.8 mm
Print Length	Batch: 12.5-640 mm Cut: 32-640 mm
Barcodes	UPC/EAN/JAN, Code 39, Code 93, Code 128, EAN 128, NW7, MSI, Interleaved 2 of 5, Industrial 2 of 5, Matrix 2 of 5, Postnet, RM4SCC, KIX-Code, Customer Barcode, GS1 Databar
2D Codes	Data Matrix, PDF417, QR Code, Maxi Code, Micro PDF417, CP Code
Fonts	Bitmap font, Outline font, Writable characters, TTF

Ribbon

Ribbon Width	120-220 mm
Ribbon Core Size	25.4 mm (1 inch)
Fixed Core Length	240 mm
Max. Ribbon Length	300 m
Max. Ribbon Diameter	72 mm

Media

Alignment	Centred
Backing Paper Width	Batch: 100-242 mm Cut: 100-235 mm
Label Thickness	0.13-0.18 mm
Tag Thickness	0.08-0.18 mm
Inner Media Core Diameter	38-76 mm
Outer media Roll Diameter	230 mm
Media Type	Vellum paper and labels, Matt coated paper, Glossy coated paper, Synthetic film, PET film, Polyimide
Media Format	Roll, Fanfold

Software & Connectivity

Printer Driver	Windows 10/8/7/Vista (32/64 bit), Windows Server 2012/Server 2008 (32/64 bit)
Interface	USB 2.0 (Full Speed), LAN 10/100 Base, Parallel port, Serial port ¹⁾
Language Mode	TPCL, BCI (function)
Label Software	BarTender UltraLite

Options

Cutter module, expansion I/O board, RS-232C board, RTC (real time clock)

¹⁾ Optional

BarTender
BY SEAGULL SCIENTIFIC
Create and automate
labels, barcodes and more



About Toshiba

Toshiba (Australia) Pty Limited is part of the globally operating Toshiba Tec Corporation, active in various high-tech industrial sectors.

Toshiba is a leading provider of information technology, operating across multiple industries - ranging from retail, education and business services to hospitality and manufacturing. With headquarters in Japan and over 80 subsidiaries worldwide, Toshiba Tec Corporation helps organisations transform the way they create, record, share, manage and display information. For more information please contact us:

TOSHIBA (Australia) Pty Limited

Building C, 12-24 Talavera Road,
North Ryde. 2113. Australia
Tel: 1300 794 202

New Zealand

32 Lunn Avenue, Mt Wellington
Tel: 09 570 8530

www.toshiba-business.com.au
www.toshiba-business.co.nz



Together Information is Toshiba's vision for how people and organisations create, record, share, manage and display ideas and data.

It is based on our belief that the most successful organisations are those that communicate information in the most efficient way .

We make that possible through an integrated portfolio of industry-specific solutions, all of which reflect Toshiba's commitment to the future of the planet.

For more information please visit www.toshiba-business.com.au